

Collins Park

502 Powell Avenue
River Falls WI 54022

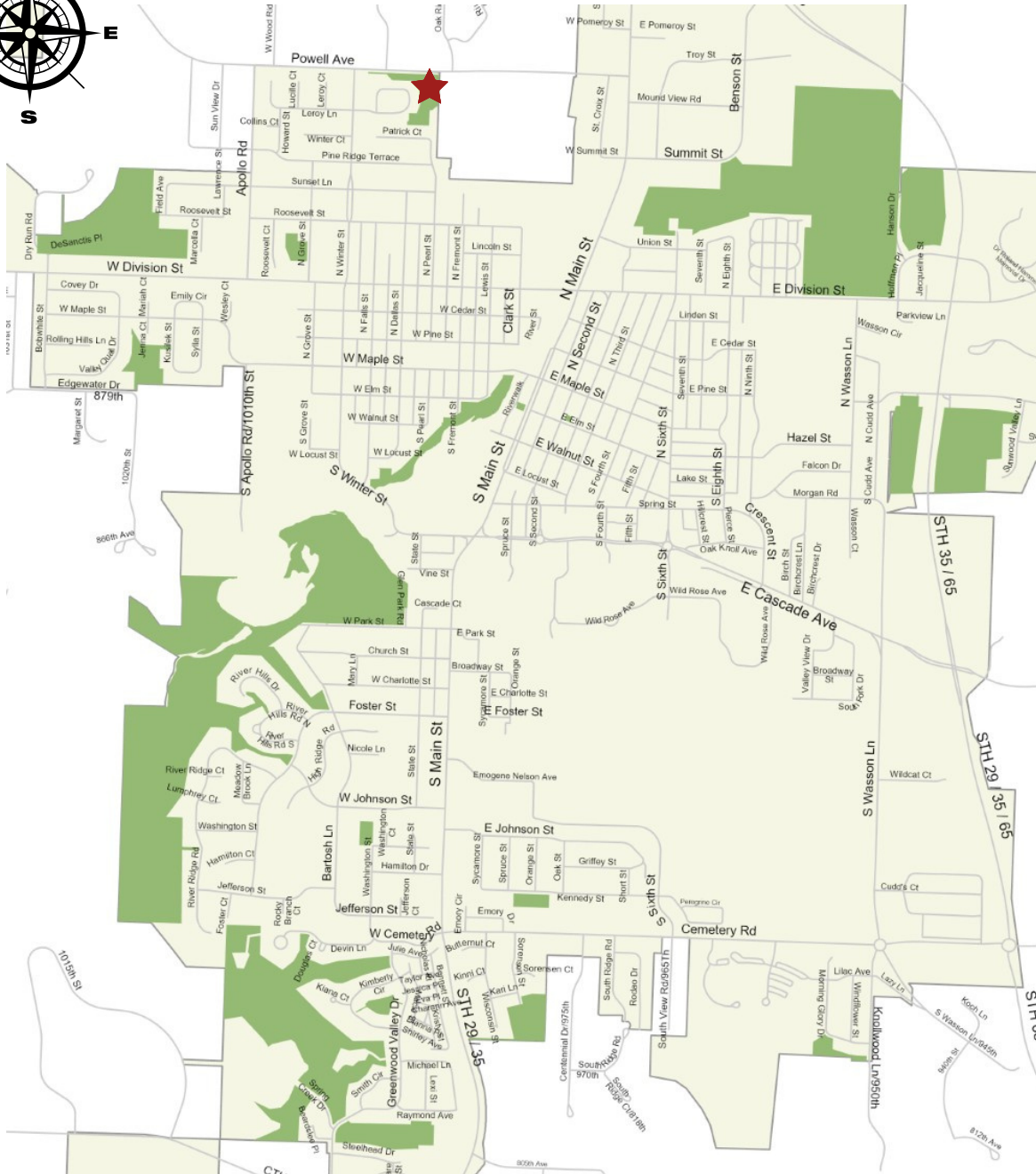
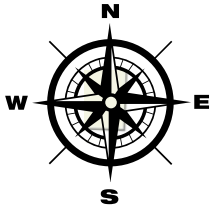

COMPLETE THIS ALL AGES PARK SCAVENGER HUNT AND BRING IT TO THE LIBRARY TO DISCUSS WITH A STAFF PERSON AND REGISTER FOR A PRIZE..

NAME _____



I SPY

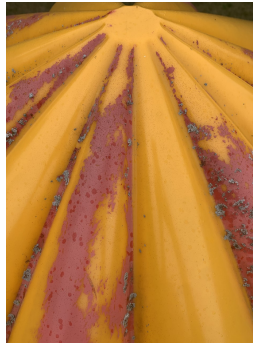

Collins Park is a little tricky to get to if you are traveling by car. There are no roads or parking lots that lead directly to the park. You will have to consult your map to figure out the best way to get there. You can park along Leroy Lane or Patrick Court and then walk along the sidewalks to get to the park. There is a "secret" sidewalk that leads from Patrick Court to the park. If you find this sign, you have found the secret sidewalk. What do the 2 other signs on either side of the sidewalk say?

On one end of the park there is a huge hole filled with grass and wildflowers. Why do you think this big hole is in the park?



Can you find where this photo is? Where do you think this goes to and why is it there?

Explore the sidewalks around the park. Where do they go?

How many sides does the pavilion have? _____ What is the name of that shape? _____

Sit inside the pavilion and sing a song. Does it sound different when you sing outside? _____
