

# Golfview East Park

1388 Golf View Drive  
River Falls WI 54022

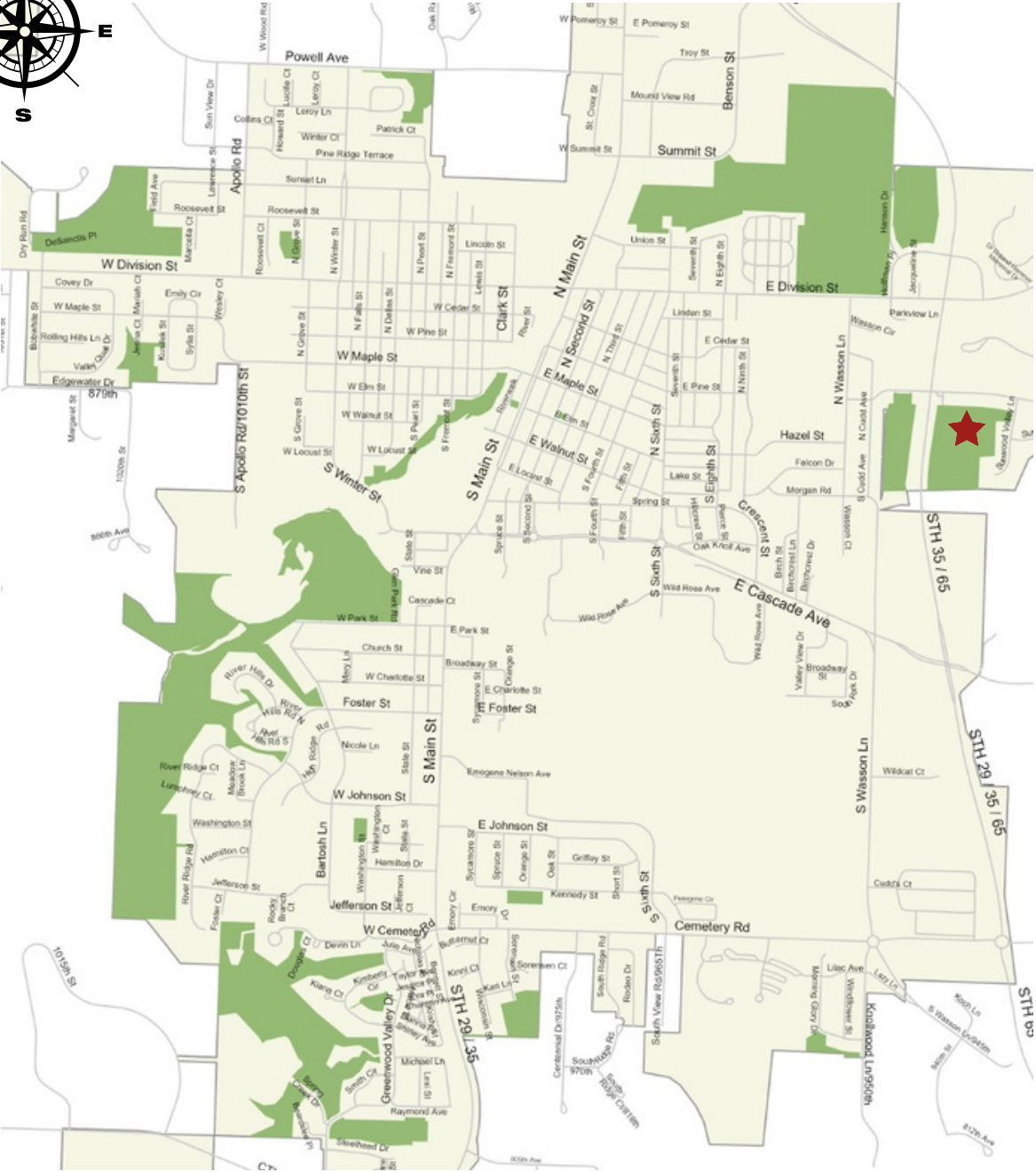
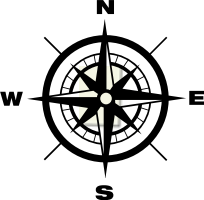

COMPLETE THIS ALL AGES PARK SCAVENGER HUNT AND BRING IT TO THE LIBRARY TO DISCUSS WITH A STAFF PERSON AND REGISTER FOR A PRIZE..

NAME \_\_\_\_\_



I  
SPY



Guess what was on my shoe when I came back to the library from touring Golfview East Park?



Golfview East Park has a few big soccer fields. **Bring a ball you can kick!** How many nets can you count on the fields? \_\_\_\_\_ How far away you can get from a net and kick a ball in to it? \_\_\_\_\_

Have you played soccer before? What do you know about the rules? Take some time to discuss or research the rules of this game and write about it. \_\_\_\_\_

One of the things you have to do while playing soccer is run. Can you run around the field and touch each net with your elbow? You can time yourself and do it again. See if you can beat your time. \_\_\_\_\_

There is a long grassy area that cuts across the field. Can you find the sidewalk to cross over it? Stop in the middle of the sidewalk. What can you hear? \_\_\_\_\_

Do you hear the highway? There are many cars driving fast along the highway. You never want to try to cross the highway by walking or riding your bike. This highway is for cars only. What is the best way to get to this park by walking or on a bike? Look at the map and plan your route. \_\_\_\_\_

What sounds do you hear coming from the grassy area? What animals do you think live in this grass? \_\_\_\_\_

Why do you think the grassy area is here? What clues can you find that support your answer? \_\_\_\_\_

Can you spot the water tower? See if you can find it on the map. When you leave the park, can you follow the map to the water tower?