

Larson Park

1800 Sorensen Street
River Falls WI 54022

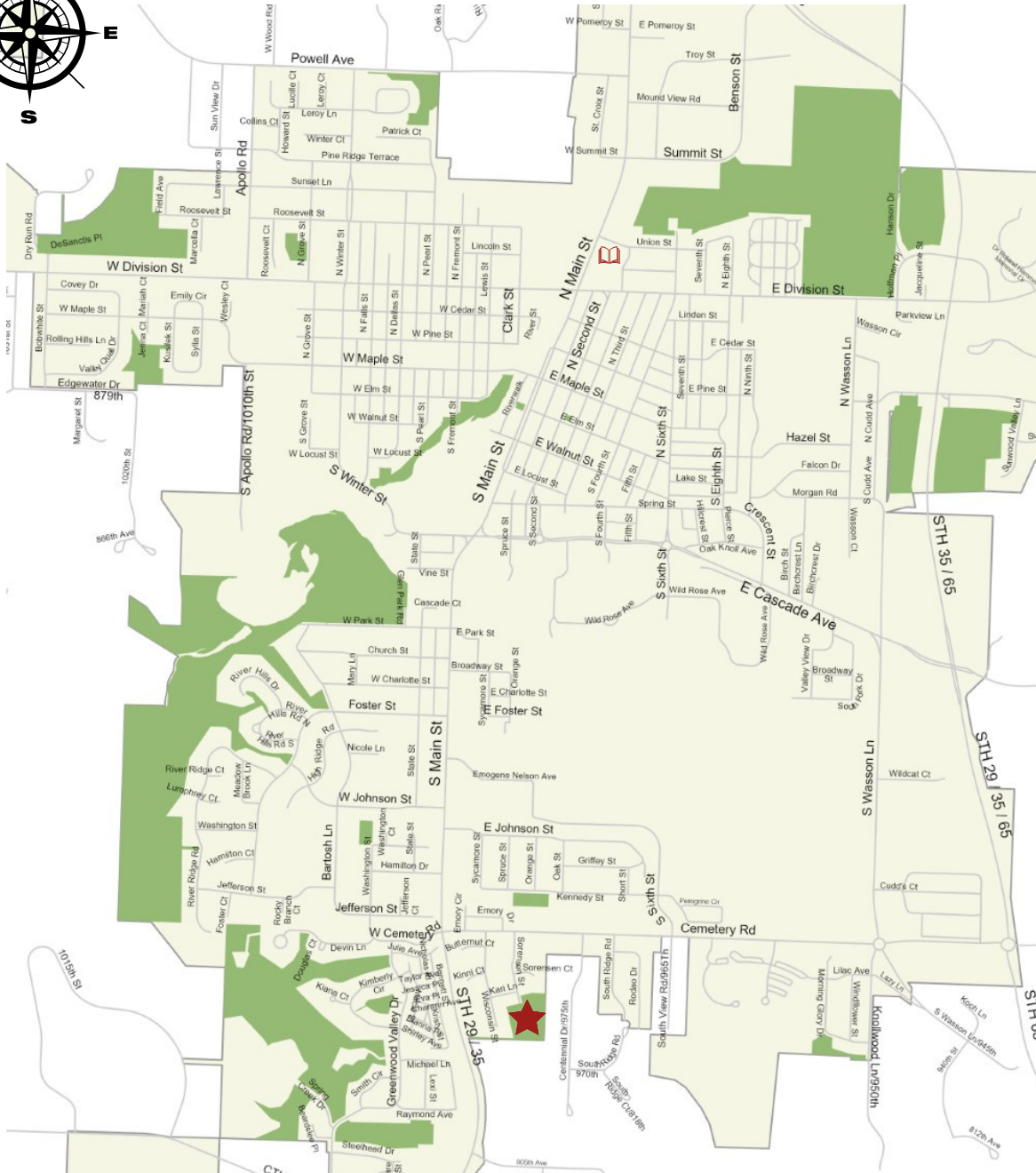
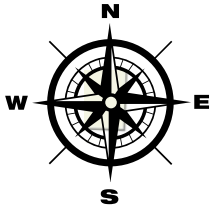

COMPLETE THIS ALL AGES PARK SCAVANGER HUNT AND BRING IT TO THE LIBRARY TO DISCUSS WITH A STAFF PERSON AND REGISTER FOR A PRIZE..

NAME _____



I
SPY
NO LIMITS



Along the parking lot at Larson Park, there is a retaining wall with a garden. Do you see the 2 big oak trees in the garden? Look closely at their leaves. Do you see the differences? Can you identify which kind of oak tree each one is? Examples are Pin Oak, Red Oak or White Oak. _____

There are some really big rocks in this garden. Can you find the rock with a linear texture?

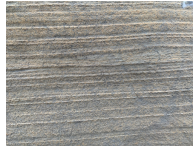

Why do you think this rock has this unique texture? _____

There are 2 special ball courts at Larson Park. What are the names of the games that are played in each court?

Larson Park has a paved trail that goes around the playground, up the hill, down the hill and around both sides of the hill. Can you walk the entire trail to get to the top of the hill? Can you find the bench at the top of the hill? That is a big hill, you must be tired now. You should sit very quietly on the bench and see if you can hear any animals. Sometimes it can be difficult to tell if the animal sound is a bug, a bird or even a squirrel. See if you can follow the sound with just your ears and your eyes to figure out where it's coming from. Do you see any movement? Can you identify any of the animals you hear without moving off the bench? _____

While still sitting on the bench, look up. You should see the branches of a tree. Look behind you. Can you identify what type of tree this is? Hint: It is not an oak tree. _____

It's almost time to walk back down the hill, but before you leave the bench, look to your right. Can you think of something that might be really fun to do in the winter at Larson Park? _____

How did you get to Larson Park? _____ What other ways could you have gotten here?
